

Anglia Handling Services Ltd.

Montgomery Way
Stratton Business Park
Biggleswade
Bedfordshire
SG18 8QB

Tel: +44 (0) 1767 312125
Fax: +44 (0) 1767 601375
sales@angliahandling.co.uk
www.angliahandling.co.uk

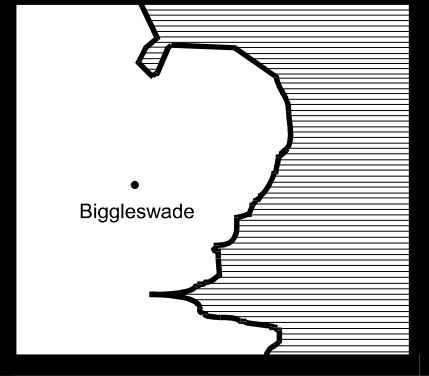

UNDER BRACED JIB CRANES

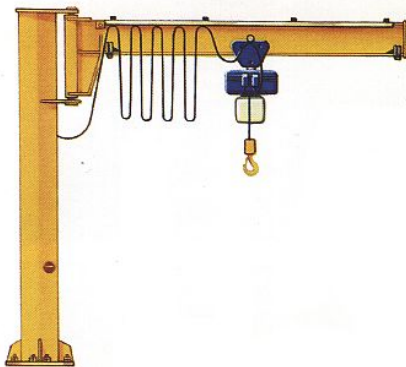

Post Mounted

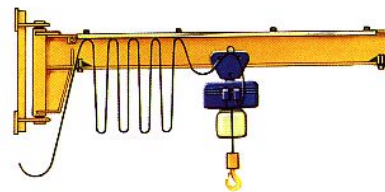

Column Mounted

An alternative jib crane design offering a cost effective lifting solution where available headroom is limited. This option is more expensive than the over braced jib crane and is available with 3 mounting options:

1. Post Mounted 290° Arm Slew – supplied with its own post and base plate
2. Post Mounted 360° Arm Slew – supplied with its own post and base plate
3. Column Mounted 250° Slew – fixed to a suitable building column

The jib arm can be made from a universal beam section that can be fitted with a hand pushed trolley, a hand geared or powered trolley. The arm slew can also be powered if required.

Safe Working Load (kg)	Arm Radius (m)					
	2	3	4	5	6	7
63						
125						
250						
500						
1000						
2000						

Directors:
A.Jefferies
K.J.Logue
D.Elleman



Registered in England No. 1545263
Vat Registration: 335 2809 59

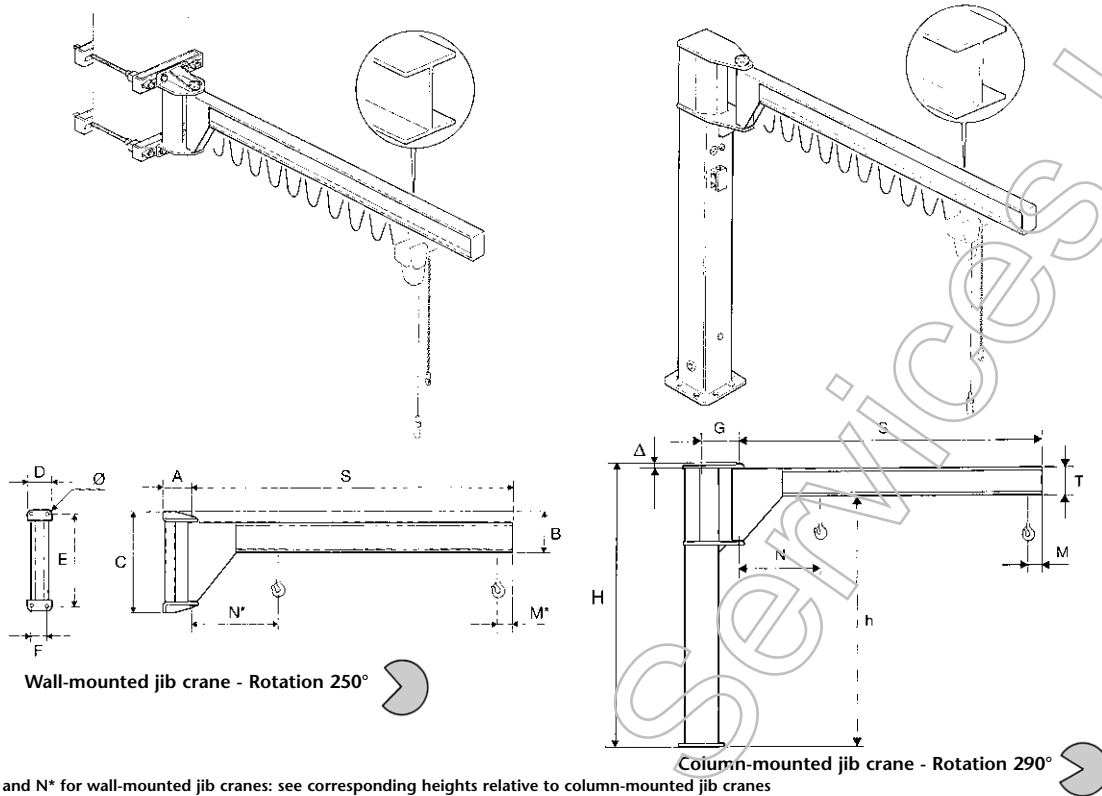

Lifting capacity	Arm		Grandezza gru
	Bracket	Column	
kg	m		
63	4	A R	
	5	A R	
125	2	A R	
	3	A R	
	4	B S	
	5	B S	
250	2	B S	
	3	B S	
	4	C T	
	5	C T	
	6	D U	
	6	E V	
	7	E V	
500	2	C T	
	3	C T	
	4	D U	
	5	D U	
	6	E V	
	6	F Z	
	7	F Z	
1000	2	D U	
	3	D U	
	4	E V	
	5	E V	
	6	F Z	
	6	F Z	
	7	F Z	
1600	6	F Z	
2000	2	E V	
	3	E V	
	4	F Z	
	5	F Z	

GBP series wall-mounted jib cranes – T version									
Type	Overall dimensions (mm)								Weight of crane
	A	B	C	D	E	F	Ø	kg	
T01A40	170	248	644	200	594	150	15	95	
T01A50	170	248	644	200	594	150	15	111	
T01A20	170	248	644	200	594	150	15	63	
T01A30	170	248	644	200	594	150	15	79	
T01B40	170	288	644	200	594	150	15	125	
T01B50	170	288	644	200	594	150	15	147	
T01B20	170	288	644	200	594	150	15	81	
T01B30	170	288	644	200	594	150	15	103	
T02C40	210	346	930	250	870	190	22	195	
T02C50	210	346	930	250	870	190	22	226	
T02D62	210	406	930	250	870	190	22	340	
T03E62	255	500	1240	300	1160	220	34	410	
T03E72	255	500	1240	300	1160	220	34	555	
T02C20	210	346	930	250	870	190	22	134	
T02C30	210	346	930	250	870	190	22	165	
T02D40	210	406	930	250	870	190	22	256	
T02D50	210	406	930	250	870	190	22	298	
T03E65	255	500	1240	300	1160	220	34	482	
T03E75	255	540	1240	300	1160	220	34	596	
T02D20	210	406	930	250	870	190	22	172	
T02D30	210	406	930	250	870	190	22	214	
T03E40	255	499	1240	300	1160	220	34	381	
T03E50	255	499	1240	300	1160	220	34	438	
T03F65	255	540	1240	300	1160	220	34	530	
T03F75	255	499	590	1240	300	1160	34	688	
T03F67	255	590	1240	300	1160	220	34	610	
T03E20	255	499	1240	300	1160	220	34	267	
T03E30	255	499	1240	300	1160	220	34	324	
T03F40	255	540	1240	300	1160	220	34	400	
T03F50	255	590	1240	300	1160	220	34	535	

GBA series column-mounted jib cranes – T version										
Total Height	Type	Under beam	Overall dimensions					Weight		
			h	G	M	N	T (PE)	Δ	Crane	Column by m
m								kg	kg	
3	5	T30R40	2800	228	190	655	160	12	148	18.2
									164	18.2
3	5	T30R30	2800	228	190	655	160	12	132	18.2
									200	22.8
3	5	T30S40	2760	274	190	725	200	12	200	22.8
									222	22.8
3	5	T30S50	2760	274	190	785	200	12	222	22.8
									156	22.8
3	5	T30S20	2760	274	190	665	200	12	156	22.8
									178	22.8
3	5	T30S30	2800	228	190	655	160	12	132	18.2
									320	35
3.5	5.5	T35T40	3212	323	190	800	240	17	320	35
									351	35
3.5	5.5	T35T50	3212	323	190	860	240	17	351	35
									190	1000
4	6	T40V62	3640	443	190	1065	300	20	705	64
									852	64
4	6	T40V72	3580	443	190	1135	360	20	852	64
									260	35
3.5	5.5	T35T20	3212	323	190	740	240	17	260	35
									290	35
3.5	5.5	T35T30	3212	323	190	800	240	17	290	35
									430	43.5
3.5	5.5	T35U40	3152	386	190	880	300	17	430	43.5
									472	43.5
3.5	5.5	T35U50	3152	386	190	940	300	17	472	43.5
									779	64
4	5	T40V65	3580	443	190	1140	360	20	779	64
									864	75.2
4	6	T40Z62	3580	513	190	1140	360	20	864	75.2
									893	64
4	4	T40V75	3540	443	190	1270	400	20	893	64
									978	75.2
4	6	T40Z72	3540	513	190	940	1270	400	978	75.2
									346	43.5
3.5	5.5	T35U20	3152	386	190	820	300	17	346	43.5
									388	43.5
3.5	5.5	T35U30	3152	386	190	880	300	17	388	43.5
									678	64
4	6	T40V40	3580	443	190	945	360	20	678	64
									735	64
4	6	T40V50	3580	443	190	1005	360	20	735	64
									912	75.2
4	4	T40Z65	3540	513	190	1190	400	20	912	75.2
									190	1270
			190	1270	450					
4	6	T40V20	3580	443	210	900	360	20	564	64
									621	64
4	6	T40V30	3580	443	210	960	360	20	621	64
									780	75.2
4	6	T40Z40	3540	513	210	1070	400	20	780	75.2
									210	1220

MBE/CBE SERIES JIB CRANE - T VERSION – MOTORISED ARM CANTILEVER VERSION

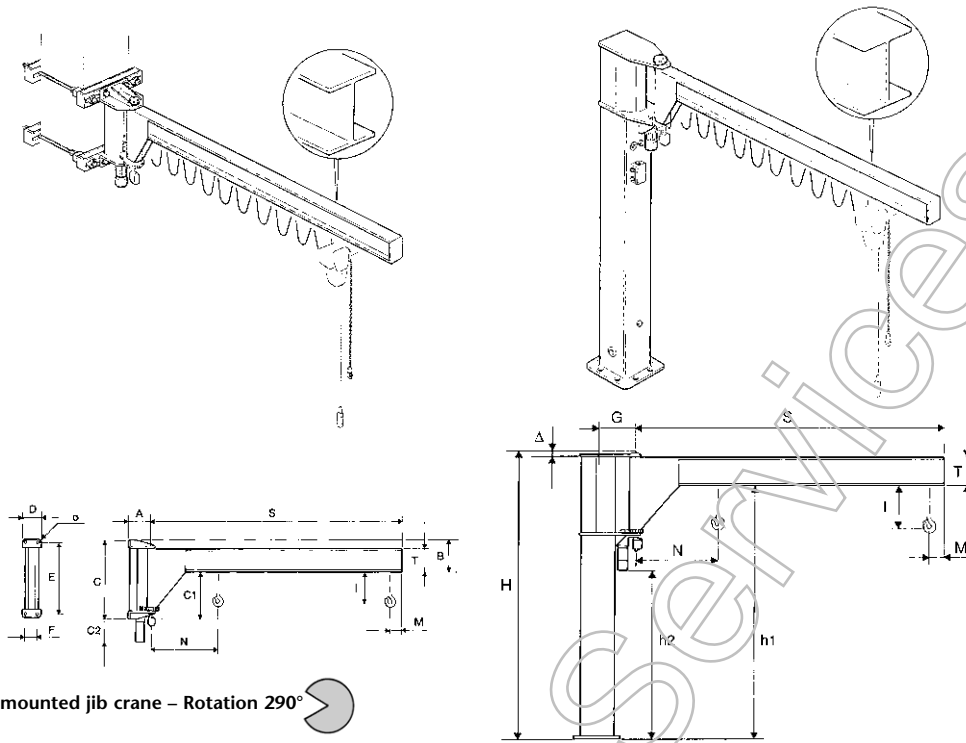

Wall-mounted jib crane – Rotation 290°

Column-mounted jib crane – Rotation 290°

Height 1: See commercial catalogue for DMK series electric chain hoist

Lifting capacity kg	Arm S m	Size of jib crane	MBE series wall-mounted jib crane – T version – Motorised arm in cantilever version																
			Overall dimensions (mm)											Speed of arm		Motor power kw	Weight of crane kg		
Type	A	B	C	C1	C2	D	E	F	Ø	M	N	T	n° of revolutions r.p.m.	peripheric m/min					
500	4	D	ET02D40	340	406	930	524	378	250	870	190	22	190	910	300	1	25	0.4	313
	5	D	ET02D50	340	406	930	524	378	250	870	190	22	190	970	300	0.8	25	0.4	355
	6	E	ET03E60	365	500	1240	740	348	300	1160	220	34	190	1080	360	0.6	23	0.4	574
	7	F	ET03E70	365	540	1240	700	348	300	1160	220	34	190	1270	400	0.6	26	0.4	680
1000	2	D	ET02D20	340	406	930	524	378	250	870	190	22	190	850	300	1.6	20	0.4	229
	3	D	ET02D30	340	406	930	524	378	250	870	190	22	190	910	300	1.2	23	0.4	271
	4	E	ET03E40	365	500	1240	740	348	300	1160	220	34	190	970	360	1	25	0.4	456
	5	F	ET03E50	365	500	1240	740	348	300	1160	220	34	190	1030	360	0.8	25	0.4	514
	6	F	ET03F60	365	500	1240	740	348	300	1160	220	34	190	1080	360	0.6	23	0.4	574
1600	6	F	ET03F67	365	590	1240	650	348	300	1160	220	34	210	1200	450	0.6	23	0.4	714
2000	2	E	ET03E20	365	500	1240	740	348	300	1160	220	34	210	930	360	1.6	20	0.4	341
	3	E	ET03E30	365	500	1240	740	348	300	1160	220	34	210	990	360	1.2	23	0.4	399
	4	F	ET03F40	365	540	1240	700	348	300	1160	220	34	210	1080	400	0.8	20	0.4	508
	5	F	ET03F50	365	590	1240	650	348	300	1160	220	34	210	1130	450	0.6	20	0.4	635

Lifting capacity kg	Arm S m	Size of jib crane	Total Height H in base max.	CBE series column-mounted jib-crane – T version – Motorised arm in cantilever version										Speed of arm	Motor power kw	Weight	
				Type	Under beam H1	h2	G	M	N	T	Δ	n° of revolutions r.p.m.	peripheric m/min			Crane kg	Column by m kg
500	4	U	3.5	ET35U40	3152	2250	436	190	910	300	17	1	25	0.4	476	43.5	
	5	U	3.5	ET35U50	3152	2250	436	190	970	300	17	0.8	25	0.4	518	43.5	
	6	V	4	ET40V60	3580	2492	463	190	1080	360	20	0.6	23	0.4	840	64	
	6	Z	4	ET40Z65	3580	2492	513	190	1080	360	20	0.6	23	0.4	927	75.2	
	7	V	4	ET40V70	3540	2452	463	190	1270	400	20	0.6	26	0.4	945	64	
	7	Z	4	ET40Z75	3540	2452	513	190	1270	400	20	0.6	26	0.4	1032	75.2	
1000	2	U	3.5	ET35U20	3152	2250	436	190	850	300	17	1.6	20	0.4	392	43.5	
	3	U	3.5	ET35U30	3152	2250	436	190	910	300	17	1.2	23	0.4	434	43.5	
	4	V	4	ET40V40	3580	2492	463	190	970	360	20	1	25	0.4	722	64	
	5	V	4	ET40V50	3580	2492	463	190	1030	360	20	0.8	25	0.4	780	64	
	6	Z	4	ET40Z60	3580	2492	513	190	1080	360	20	0.6	23	0.4	927	75.2	
2000	2	V	4	ET40V20	3580	2492	463	210	930	360	20	1.6	20	0.4	607	64	
	3	V	4	ET40V30	3580	2492	463	210	990	360	20	1.2	23	0.4	665	64	
	4	Z	4	ET40Z40	3540	2492	513	210	1080	400	20	0.8	20	0.4	832	75.2	