

## Collared Eyebolts with Egg Links

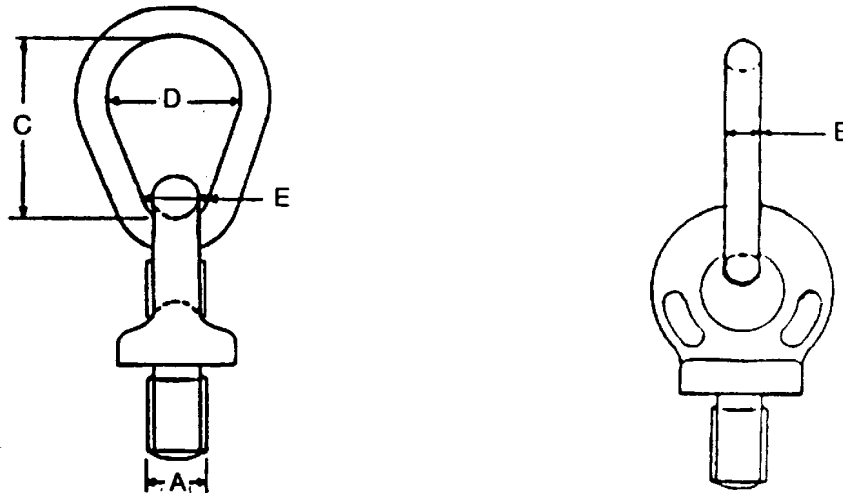

### METRIC COURSE THREADS

Vertical SWL Tonnes	A mm	B mm	C mm	D mm	E mm	Weight Each kg
0.15	8	11	70	35	15	0.22
0.25	10	11	70	35	15	0.22
0.40	12	11	70	35	15	0.23
0.80	16	16	100	50	22	0.62
1.60	20	19	120	55	25	1.17
2.50	24	25	152	76	35	2.00

### BSW THREADS

Vertical SWL Tonnes	A in	B in	C in	D in	E in	Weight Each kg
0.25	3/8	7/16	2.3/4	1.3/8	5/8	0.21
0.50	1/2	7/16	2.3/4	1.3/8	5/8	0.29
0.90	5/8	5/8	4	2	7/8	0.73
1.40	3/4	3/4	4.3/4	2.1/4	1	1.19
2.00	7/8	7/8	5.3/8	2.5/8	1.1/8	1.91

*Other thread sizes are also available.*