

Swivel Hoist Rings

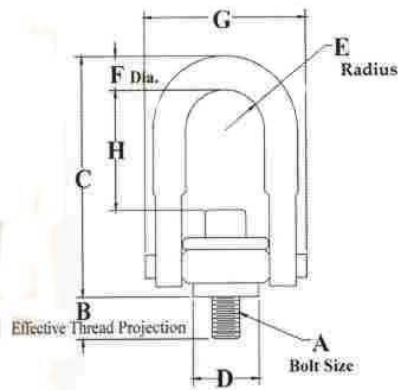

UNC Threads

Working Load Limit (lbs.)	Torque in (Ft. Lbs.)	Bolt Size A (in.)	Effective Thread Projection B (in.)	C (in.)	D (in.)	E (in.)	F (in.)	G (in.)	H (in.)	Estimated Weight (lbs.)
800	7	5/16 - 18 x 1.50	0.59	2.68	1.00	0.45	0.38	1.75	1.11	0.38
1000	12	3/8 - 16 x 1.50	0.59	2.68	1.00	0.45	0.38	1.75	1.09	0.38
2500	28	1/2 - 13 x 2.00	0.71	4.90	2.00	0.89	0.75	3.30	2.29	2.50
2500	28	1/2 - 13 x 2.50	1.21	4.90	2.00	0.89	0.75	3.30	2.29	2.50
4000	60	5/8 - 11 x 2.00	0.71	4.90	2.00	0.89	0.75	3.30	2.21	2.70
4000	60	5/8 - 11 x 2.75	1.46	4.90	2.00	0.89	0.75	3.30	2.21	2.70
5000	100	3/4 - 10 x 2.25	0.96	4.90	2.00	0.89	0.75	3.30	2.05	3.00
5000	100	3/4 - 10 x 2.75	1.46	4.90	2.00	0.89	0.75	3.30	2.05	3.00
7000	100	3/4 - 10 x 2.75	0.90	6.58	3.00	1.40	1.00	4.80	2.98	7.50
7000	100	3/4 - 10 x 3.50	1.65	6.58	3.00	1.40	1.00	4.80	2.98	7.50
8000	160	7/8 - 9 x 2.75	0.90	6.58	3.00	1.40	1.00	4.80	2.95	7.50
8000	160	7/8 - 9 x 3.50	1.65	6.58	3.00	1.40	1.00	4.80	2.95	7.50
10000	230	1 - 8 x 3.00	1.15	6.58	3.00	1.40	1.00	4.80	2.73	7.50
10000	230	1 - 8 x 4.00	2.15	6.58	3.00	1.40	1.00	4.80	2.73	7.50
15000	470	1 1/4 - 7 x 4.50	2.34	9.01	3.75	1.75	1.25	6.00	4.89	14.00
24000	800	1 1/2 - 6 x 6.50	2.98	12.41	4.75	2.25	1.75	8.00	5.93	33.00
30000	1100	2 - 4 1/2 x 6.50	2.98	12.41	4.75	2.25	1.75	8.00	5.43	36.00

Metric Threads

Working Load Limit @ 5:1 (kg)	Working Load Limit @ 4:1 (kg)	Torque in (Nm)	Bolt Size A (mm)	Effective Thread Projection B (mm)	C (mm)	D (mm)	E (mm)	F (mm)	G (mm)	H (mm)	Estimated Weight (kg)
400	500	10	M8 x 1.25 x 40	16.9	68.1	25.4	11.4	9.5	44.5	28.2	0.17
450	550	16	M10 x 1.50 x 40	16.9	68.1	25.4	11.4	9.5	44.5	27.69	0.17
1050	1300	38	M12 x 1.75 x 50	17.2	124.5	50.8	22.5	19.0	88.9	58.17	1.13
1900	2400	81	M16 x 2.00 x 60	27.2	124.5	50.8	22.5	19.0	88.9	56.13	1.22
2150	2700	136	M20 x 2.50 x 65	31.2	124.5	50.8	22.5	19.0	88.9	52.07	1.36
3000	3750	136	M20 x 2.50 x 75	28.1	167.0	76.2	35.6	25.4	127.0	75.69	3.40
4200	6250	312	M24 x 3.00 x 80	33.1	167.0	76.2	35.6	25.4	127.0	74.93	3.40
7000	8750	637	M30 x 3.50 x 100	45.1	231.5	101.6	44.5	32.0	152.4	69.34	6.35
11000	13750	1005	M36 x 4.00 x 150	60.6	315.3	127.0	57.1	44.5	203.2	124.20	14.97
12500	15600	1005	M42 x 4.50 x 160	70.6	315.3	127.0	57.1	44.5	203.2	150.62	16.33
13500	16900	1350	M48 x 5.00 x 160	70.6	315.3	127.0	57.1	44.5	203.2	137.92	16.33

Other thread sizes are also available.