



315

## Flat Grab



Fig. 1 - FG

Application Made for Patent.

- *Safe Transport of Concrete Parts via High Pressure*
- *Adjustable Suspension Eye for Center of Gravity Compensation*

**FGS**

## Flat Grab FGS with Adjustable Suspension Eye for the Safe Handling of Concrete Parts.

Fig. 2 - FGS



The Flat Grab FGS was developed for handling rough stones and concrete parts with parallel surfaces.

The high pressure guarantees safe handling. One clamping jaw is adjustable. The narrow construction of the second clamping jaw is welded to one end of the beam. This narrow construction enables the grasping, tensioning and the safe **upright setting** of horizontally positioned concrete parts. Due to the **adjustable suspension ring**, e.g. L-shaped stones can be put into an upright position.

The FGS is equipped with **exchangeable rubber coatings**.

The FGS can be used near to the ground together with any lifting equipment.

For picking up the load, a bolt is pulled which snaps in by itself when the load is put down and the grab **opens automatically**.

Due to a high-strength chain the FGS has a **low net weight**. The guide handle enables an **exact positioning** of the load. The grab is coloured orange, RAL 2000. The beam and the connecting elements are galvanized. The application has been made for patent.

Fig. 3 - FGS

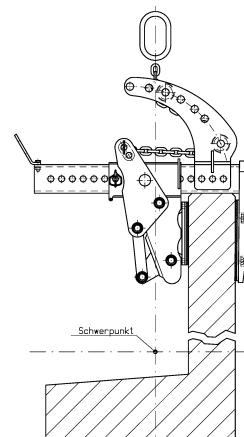
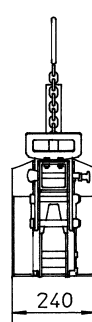
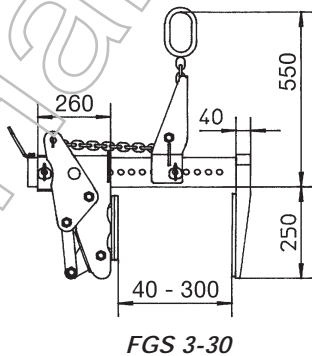
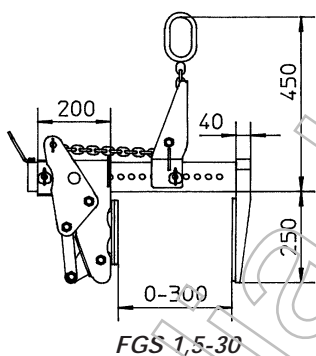

FGS with special suspension for L-shaped stones

| Order No. | Model                         | Carrying Capacity | Clamping Range | Weight |
|-----------|-------------------------------|-------------------|----------------|--------|
| 315 030   | FGS 1.5-30                    | 1,500 kg          | 0 - 300 mm     | 47 kg  |
| 315 035   | Special suspension FGS 1,5-30 |                   |                |        |
| 315 040   | FGS 3-30                      | 3,000 kg          | 40 - 300 mm    | 81 kg  |
| 315 045   | Special suspension FGS 3-30   |                   |                |        |

## FG / FGB

# Flat Grab FG / FGB for the Safe Handling of Wide Loads.

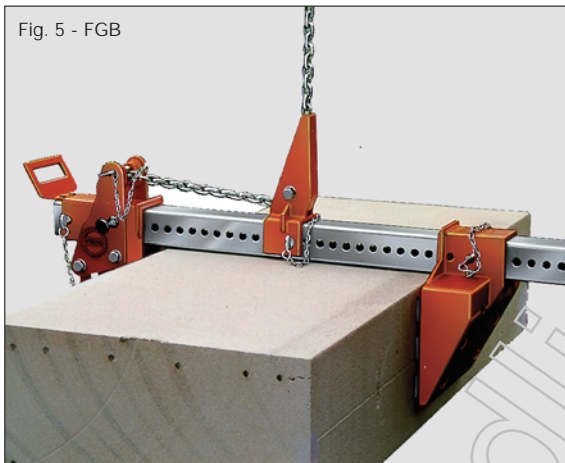
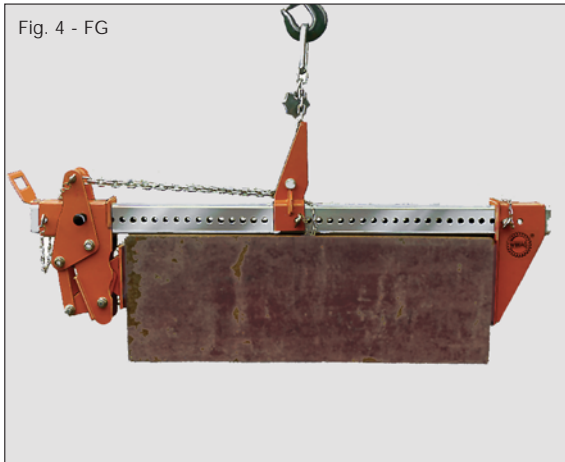

The Flat Grab FG was developed for the handling of rough stones and concrete parts with parallel surfaces.

**High pressure** guarantees safe handling.

The complete clamping range of both clamping jaws is adjustable.

Due to the **adjustable suspension eye**, parts with an eccentric center of gravity can also be held in a horizontal position. The FG is equipped with exchangeable rubber coatings.

The Flat Grab FG can be used near to the ground with any lifting equipment.

For picking up the load, a bolt is pulled which snaps in by itself when the load is put down and the grab **opens automatically**.

Due to a high-strength chain the FG has a **low net weight**.

The model **FGB** has wide clamping jaws and is used for handling delicate parts.

The grab is coloured orange, RAL 2000. The beam and the connecting elements are galvanized.

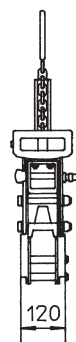
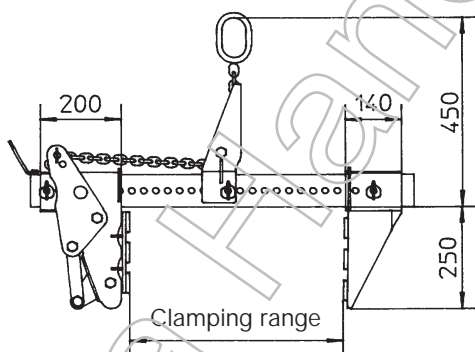

FG

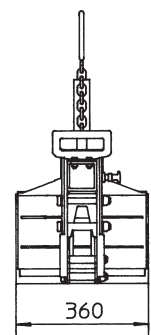

FGB

| Order No. | Model        | Carrying Capacity | Clamping Range | Jaw Width | Weight |
|-----------|--------------|-------------------|----------------|-----------|--------|
| 315 050   | FG 1.5- 50   | 1,500 kg          | 0- 500 mm      | 120 mm    | 40 kg  |
| 315 100   | FG 1.5- 100  | 1,500 kg          | 0- 1,000 mm    | 120 mm    | 47 kg  |
| 315 150   | FGB 1.5- 50  | 1,500 kg          | 0- 500 mm      | 360 mm    | 54 kg  |
| 315 200   | FGB 1.5- 100 | 1,500 kg          | 0- 1,000 mm    | 360 mm    | 60 kg  |



**PG**

## Plate Grab PG for the Safe Handling of Plates from a Horizontal Position



Fig. 6 - PG

The Plate Grab PG was developed for handling rough plates with parallel surfaces. The high lever transmission guarantees **high pressure**. By turning the clamping jaws, parts can also be gripped from the inside. The PG is equipped with exchangeable rubber coatings. The equipment is orange in colour, RAL 2000.

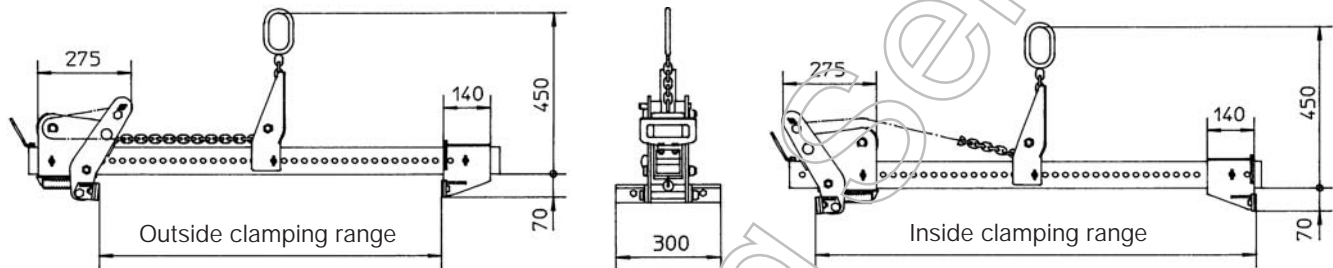

| Order No. | Model      | Carrying Capacity | Outside Clamping Range | Inside Clamping Range | Weight approx. |
|-----------|------------|-------------------|------------------------|-----------------------|----------------|
| 315 400   | PG 1.5-100 | 1,500 kg          | 0 - 1,000 mm           | 450 - 1,350 mm        | 44 kg          |

### Special Constructions

The Accident Prevention Regulation VBG 9a "Load-Handling Equipment for Hoisting System Service" requires a protective device for the operation of grabs **near to the ground** to prevent the load or parts of the load from falling down. The following special constructions have already been built:

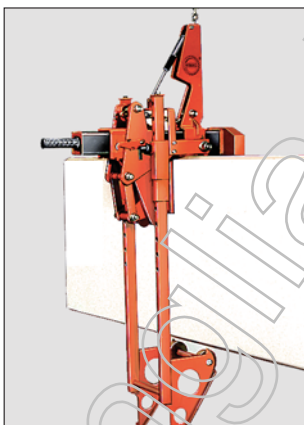

Flat Grab equipped with a catch hook for the laying of AAC wall panels near to the ground.



Flat Grab FGB-4.5-95 special construction, carrying capacity 4,500 kg clamping range 450-950 mm.

Enquire about our special constructions.