

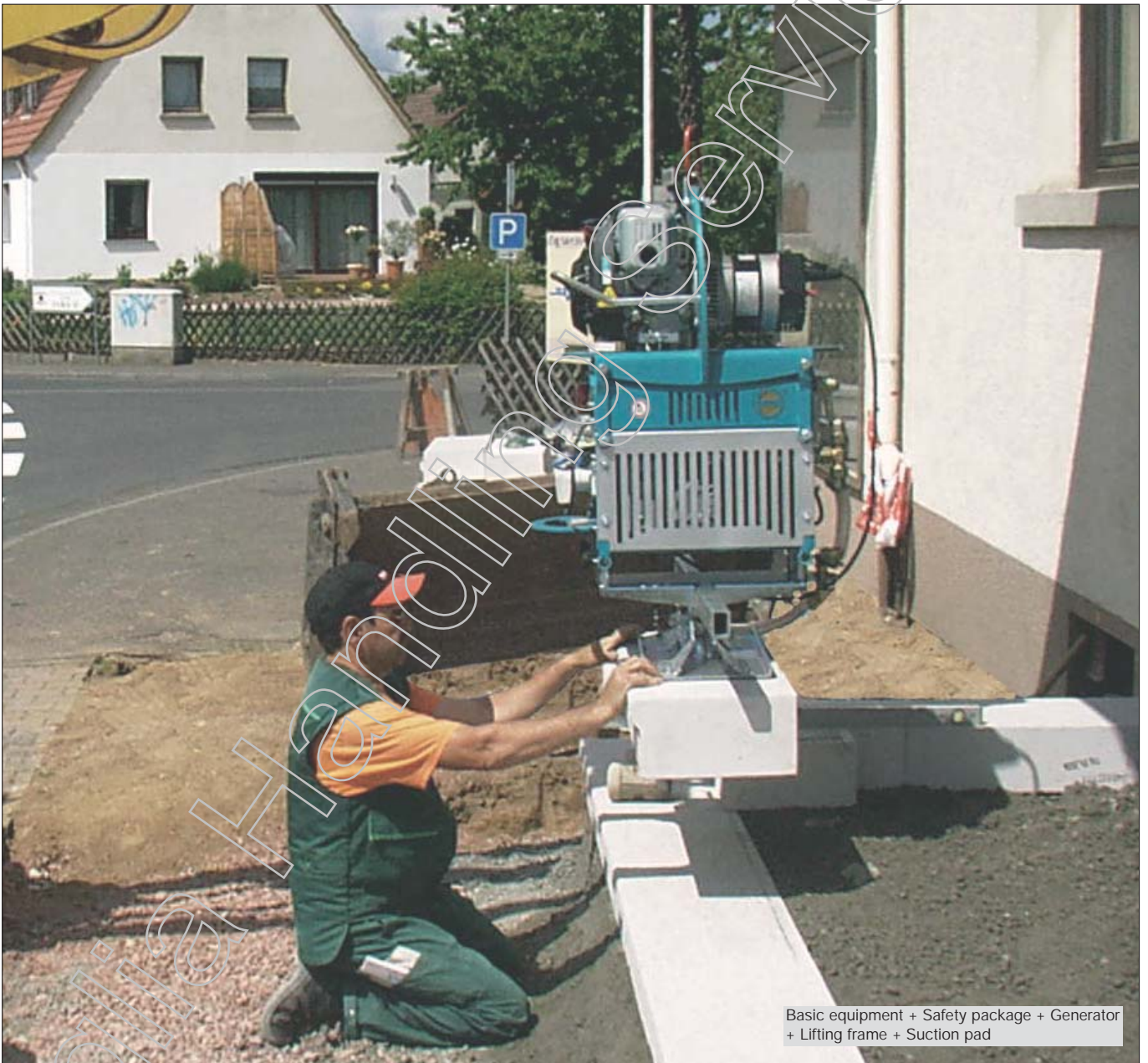

840

## Uni-Llevator



*The universal lifter is of modular construction:  
For manual and machine hoisting operation*

***You are looking for a vacuum lifter for manual operation, but you want to lift heavy blocks using your excavator as well?***

***No problem with our Uni-Levator.***

The Uni-Levator is of modular construction for nearly any kind of operation and material, like natural and concrete stones. The powerful pump controls difficult material and surfaces, like e.g. steps or kerbstones. The single components are quickly exchangeable.

The plates are manually applicable?

No problem; just take the basic equipment, which can be equipped with four wheels for easy movement, connect e.g. the 2-point lifting frame to the hose pipe of 5 m length. Where no mains are available, just use the generator.

The plates are machine applicable?

Also no problem. Take your basic equipment, suction pad, safety package and the generator, if necessary. Fit in the load hook and start.

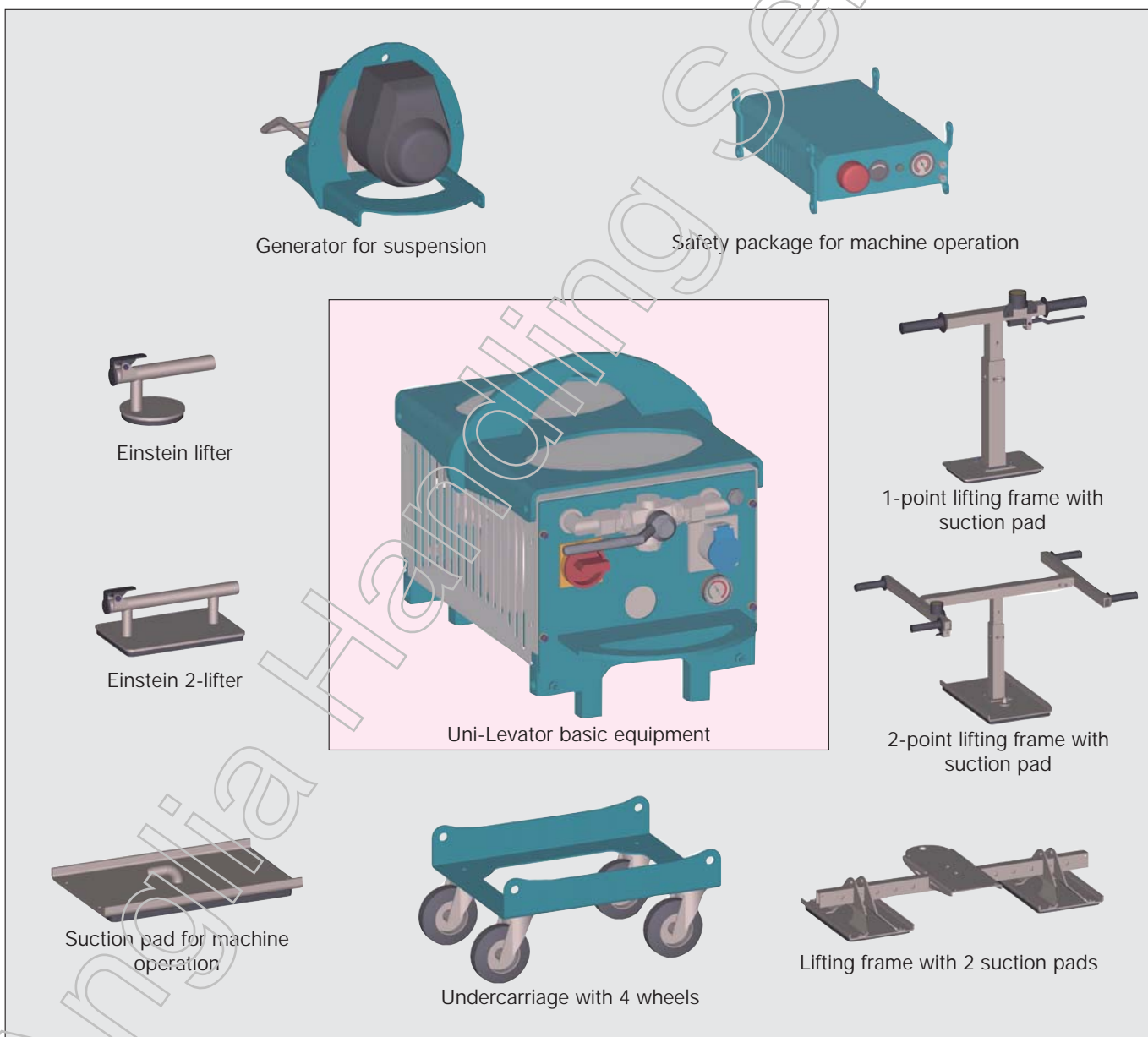

## Specification

Order No.



### **Uni-Levator**

Basic equipment with 10 m feeding cable and suspension, electric mains 230 V - 50 Hz, the vane-type rotary pump is designed for permanent use and reaches 95% vacuum. Furthermore it is very quietly running and low vibration 60dB(A). Carrying capacity up to 2.5 t, depending on lifting frame, suction pads and material.  
Dimensions 600 x 350 x 400 mm - 60 kg

840 100



### **Safety package for machine operation**

Visual and acoustic warning sign, vacuum storage, manometer, voltmeter.  
470 x 350 x 120 mm - 20 kg

840 200

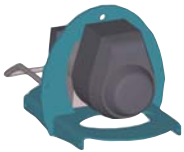

### **Generator for suspension**

Honda petrol engine with generator 1.5 KVA, 230 V - 50 Hz, manually operated starting.  
500 x 400 x 400 mm - 40 kg

840 300



### **Undercarriage with 4 wheels**

for easy movement. 2 wheels equipped with wheel stop.

840 110



### **Suction pad for machine hoisting operation**

Carrying capacity 400 kg<sup>2</sup> / 200 kg<sup>1</sup>  
260 x 460 mm - 7 kg

840 150



### **Lifting frame with 2 suction pads**

Carrying capacity 800 kg<sup>2</sup> / 400 kg<sup>1</sup>, length of frame 1.500 mm, suction pads turn through 90°. Dimension of suction pad 260 x 460 mm

840 160



### **1-point lifting frame**

Height adjustable, aluminium construction, with 5 m hose pipe

840 121



### **2-point lifting frame**

Height and width adjustable, aluminium construction with 5 m hose pipe

840 131



### **Suction pad 1 for 1-point and 2-point lifting frame**

Carrying capacity 50 kg<sup>1</sup>, 150 x 260 mm

840 140



### **Suction pad 2 for 1-point and 2-point lifting frame**

Carrying capacity 150 kg<sup>1</sup>, 260 x 460 mm

840 151



### **Einstein lifter**

with 5 m hose pipe, suction pad Ø 100 mm, carrying capacity 15 kg<sup>1</sup>

840 170



### **Einstein 2 lifter**

with 5 m hose pipe, suction pad 150 x 230 mm, carrying capacity 50 kg<sup>1</sup>

840 171

Special accessories like tie bars and suction pads with higher capacities or suction pads for preforms on request.

<sup>1</sup> in case of low pressure of at least -0.6 bar, <sup>2</sup> in case of low pressure of at least -0.9 bar



# Applications



Basic equipment + safety package + generator for suspension + suction pad for machine hoisting operation

Basic equipment with lifting frame and 2 suction pads



Quality control in a production line of concrete stones

Basic equipment with undercarriage and Einstein lifter